

BUILT TO RESIST

APPLICATION

Electronic controller

BENEFITS

- Closed loop
- Signal and not power electronics (simplified switchboard)
- Normal electric motor, rotates at fixed speed (no servo-ventilation), little stress
- The power part stays on the variator:
 - wide speed range 0-1500 rpm (0-1750 rpm using 60Hz motor)
 - high torques at low revolutions
- Suitable for difficult, humid and dusty environments
- Precise speed control about 1 rpm

CLOSED-LOOP OPERATION

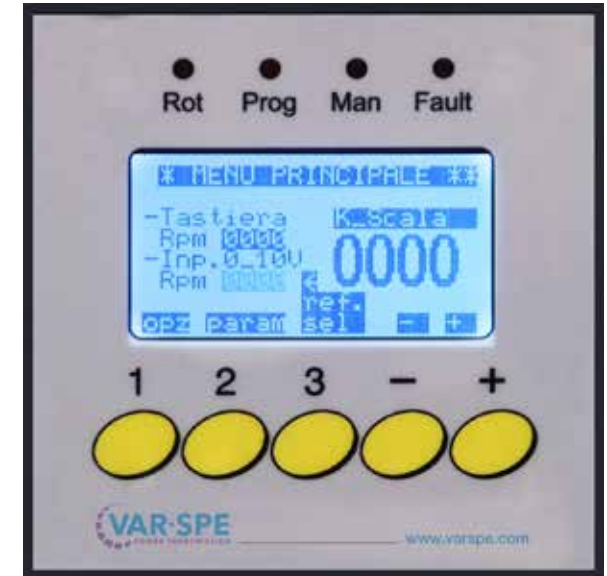
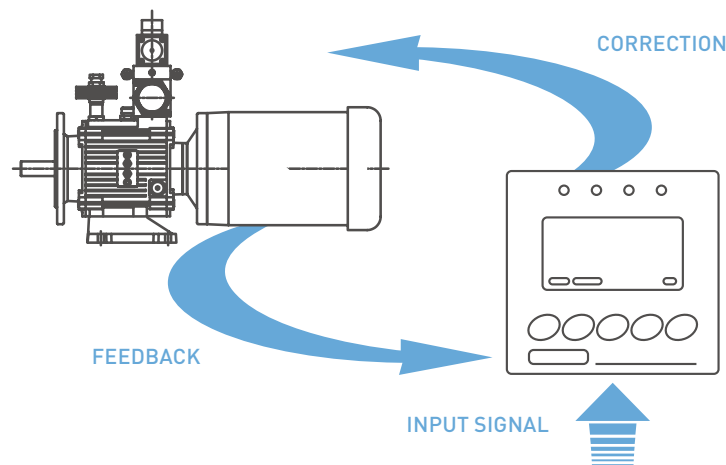

CHARACTERISTICS

- Inputs:
 - 4-20mA / 0-20mA
 - 0-10V / 0-5V
 - potentiometer
 - Keypad
 - 4 digital inputs
- Power supply 24Vdc or 24Vac
- Wide display
- Speed display through scale factor
- Acceleration and deceleration ramps
- Alarm (bypassable)



BUILT TO RESIST



- HARD ENVIRONMENTS
- LONG SERVICE LIFE
- RELIABILITY



PRODUCT RANGE



K2 (0,37-0,55-0,75 kW)



K4 (1,1-1,5 kW)



K5 (2,2-3-4 kW)



15 (3-4 kW)



16 (5,5-7,5 kW) **16B** (11 kW)



17 (15 kW) **17B** (22 kW)

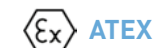

ATEX

Atex-certified variators
(0,37-22 kW)

VAR-SPE SRL
Via Cordellina, 81 36077 Altavilla Vicentina (VI) Italia

Tel. +39 0444 572.011
Fax +39 0444 573.188

www.varspe.com
info@varspe.com